



## 44 Seacole Gardens

, Southampton, SO16 6PN

**£950 Per month**

One Double Bedroom Apartment | Allocated Parking | White Goods Included | Lift Access | Bike Storage | Juliette Balcony | Unfurnished | Available August 1st 2026 | All Viewings On 15th July 2026 Only as Tenant Still in Situ

- One Double Bedroom
- Allocated Parking
- Available from 1st August 2026
- All Viewings 15th June 2026
- UNFURNISHED With White Goods Included
- Lift Access to Second Floor Apartment
- Close to Southampton Hospital
- Well Presented Inside
- Ample Storage
- No Pets Allowed In The Building



Please contact our ROK Marsh Office on 02393233267 if you wish to arrange a viewing appointment for this property or require further information.



# Floor Plan

# Area Map

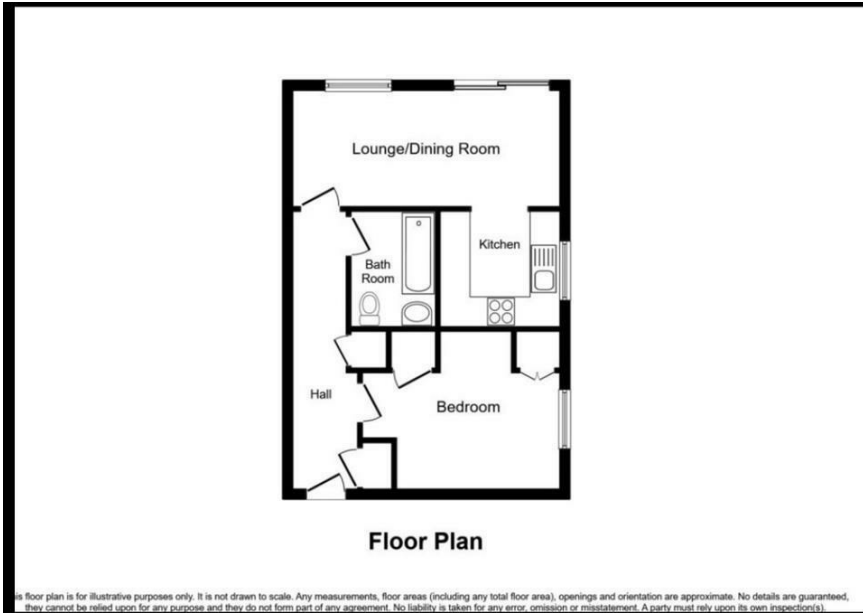

**Floor Plan**



# Energy Efficiency Graph

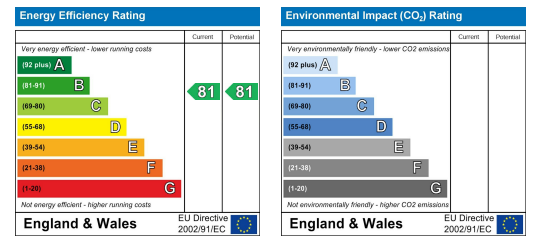

These particulars, whilst believed to be accurate are set out as a general outline only for guidance and do not constitute any part of an offer or contract. Intending purchasers should not rely on them as statements of representation of fact, but must satisfy themselves by inspection or otherwise as to their accuracy. No person in this firm's employment has the authority to make or give any representation or warranty in respect of the property.